

# Tapered Thread Standard Dimensions

Category			Nipple (mm)		Socket(mm)			Effective Diameter (mm)	Pitch (mm)
			Maximum Diameter	Length	Core Diameter	Depth	Thread Length		
New Name	Old Name	A	L	D	S	T	B	P	
3 TPI	215T3N	14T3	215.90	304.80	207.47	158.40	154.40	211.69	8.467
	241T3N	16T3	241.30	338.70	232.87	175.30	171.30	237.09	8.467
	273T3N	18T3-1	273.05	355.60	264.62	183.80	179.80	268.84	8.467
	241T3N	18T3-2	241.30	338.70	232.87	175.30	171.30	237.09	8.467
	298T3N	20T3-1	298.45	372.60	290.02	192.20	188.20	294.24	8.467
	273T3N	20T3-2	273.05	355.60	264.62	183.80	179.80	268.84	8.467
	298T3N	22T3-2	298.45	372.60	290.02	192.20	188.20	294.24	8.467
4 TPI	298T4N	22T4	298.45	355.60	292.13	183.80	179.80	295.29	6.350
	298T4L	22T4L	298.45	457.20	292.13	234.60	230.60	295.29	6.350
	317T4N	24T4	317.50	355.60	311.18	183.80	179.80	314.34	6.350
	317T4L	24T4L	317.50	457.20	311.18	234.60	230.60	314.34	6.350
	355T4L	26T4L	355.60	558.80	349.28	285.40	281.40	352.44	6.350
	374T4L	28T4L	374.65	558.80	368.33	285.40	281.40	371.49	6.350
	406T4N	30T4L	406.40	609.60	400.08	310.80	306.80	403.24	6.350
	—	32T4L	431.80	635.00	428.64	323.50	319.50	431.80	6.350

- See JIS R 7201 for more details.
- TPI indicate a number of how many threads there are in one inch.
- Please consult us concerning socket and nipple combinations that are not specified in the above table.

### ■ Nipple Details

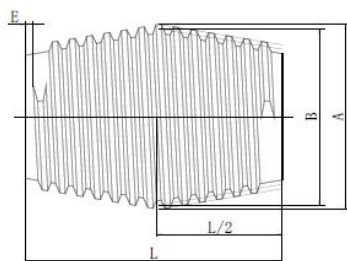

### ■ Thread Details 3 TPI (Pitch length 8.467mm)

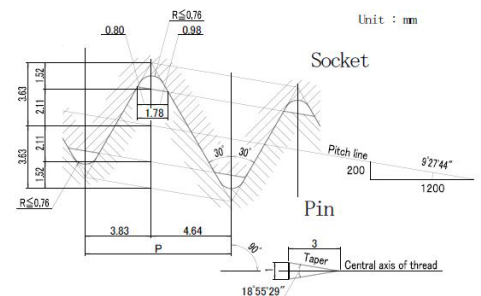

### ■ Socket Details

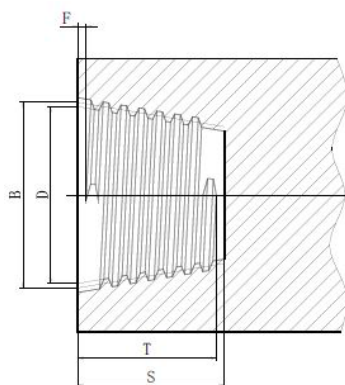

### ■ Thread Details 4 TPI (Pitch length 6.350mm)

